

High light efficiency seamless connection LED linear light

1813B

Product Feature

- Ultra-thin LED linear light bar, uniform light output
- Diverse quick connection system
- Perfect color consistency
- Perfect seamless connection, no dark areas between lamps
- Magnetic installation, convenient and fast
- Used with DC12/24V constant voltage LED driver
- Used for display, shelves, furniture, RVs and other occasions lighting



Multiple Options



1813B-CTP
Power input cable



1813B-ETEC
End-to-end connection cable



1813B-SFA/B
Side input power supply system



1813B-LL/R
Horizontal right angle connector



1813B-LU
Vertical upward connector

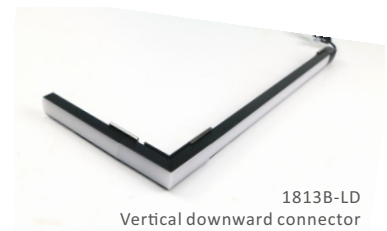

1813B-LD
Vertical downward connector

Parameters

Part No.	Input Vol.	Power	Lumen	Light Efficiency	CRI	CCT	Operating Temp.
1813B-095	DC24V	1.5W	127.5lm	85lm/W	Ra>90	2700K/3000K/4000K6000K	0~45 °C
1813B-285	DC24V	4.5W	382.5lm	85lm/W	Ra>90	2700K/3000K/4000K6000K	0~45 °C
1813B-570	DC24V	9.0W	765.0lm	85lm/W	Ra>90	2700K/3000K/4000K6000K	0~45 °C
1813B-SFA/B	DC24V	1.5W	127.5lm	85lm/W	Ra>90	2700K/3000K/4000K6000K	0~45 °C
1813B-LL/R/U/D	DC24V	1.5W	127.5lm	85lm/W	Ra>90	2700K/3000K/4000K6000K	0~45 °C

■ Dimension

Part No.	Power (w)	Input Vol. (v)	L (mm)	L1 (mm)	L2 (mm)
1813B-095	1.50	24	95.0	124.0	118.0
1813B-285	4.50	24	285.0	314.0	308.0
1813B-570	9.00	24	570.0	599.0	593.0

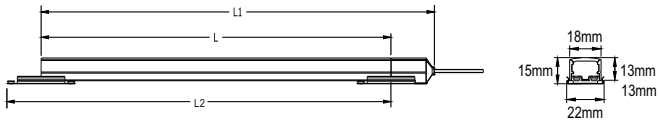

LED light connector

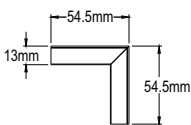
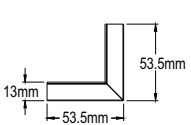
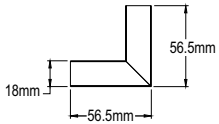

Side input power supply LED light module

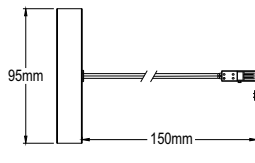

■ Installation

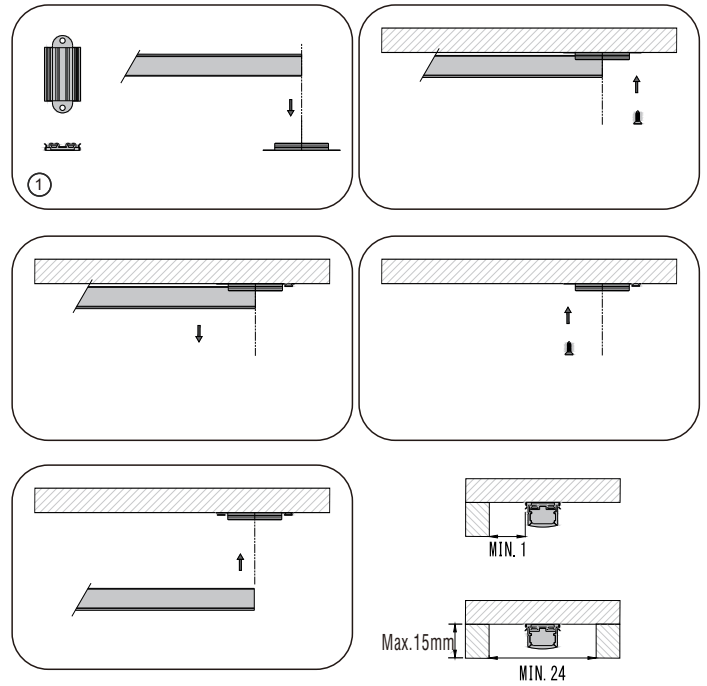

■ Accessory

<p>Side input power supply LED light module 1813B-SFA/SFB</p> <p>Used for constant voltage LED driver power for magnetic power track, or magnetic power track to power others lamp L= 15cm MAX: 4.0A</p>			
<p>Horizontal left Led light connector 1813B-LL</p> <p>Used for horizontal left connection of the magnetic LED linear light, 1.5w</p>			
<p>Horizontal right Led light connector 1813B-LR</p> <p>Used for horizontal right connection of the magnetic LED linear light, 1.5w</p>			
<p>Vertical upward Led light connector 1813B-LU</p> <p>Used for Vertical upward connection of the magnetic LED linear light, 1.5w</p>			
<p>Vertical downward Led light connector 1813A-LD</p> <p>Used for Vertical downward connection of the magnetic LED linear light, 1.5w</p>			
<p>Power input cable TB-F-CTP</p> <table border="1"> <tr> <td>TB-F-CTP-030 L=30cm, Max: 4.0A</td> <td>TB-F-CTP-200 L=200cm, Max: 4.0A</td> </tr> </table>	TB-F-CTP-030 L=30cm, Max: 4.0A	TB-F-CTP-200 L=200cm, Max: 4.0A	
TB-F-CTP-030 L=30cm, Max: 4.0A	TB-F-CTP-200 L=200cm, Max: 4.0A		
<p>End-to-end connection cable TB-F-ETEC</p> <table border="1"> <tr> <td>TB-F-ETEC-030 L=30cm, Max: 4.0A</td> <td>TB-F-ETEC-200 L=200cm, Max: 4.0A</td> </tr> </table>	TB-F-ETEC-030 L=30cm, Max: 4.0A	TB-F-ETEC-200 L=200cm, Max: 4.0A	
TB-F-ETEC-030 L=30cm, Max: 4.0A	TB-F-ETEC-200 L=200cm, Max: 4.0A		
<p>Mounting clip with end-to-end connector: 1813B-JT</p>			